

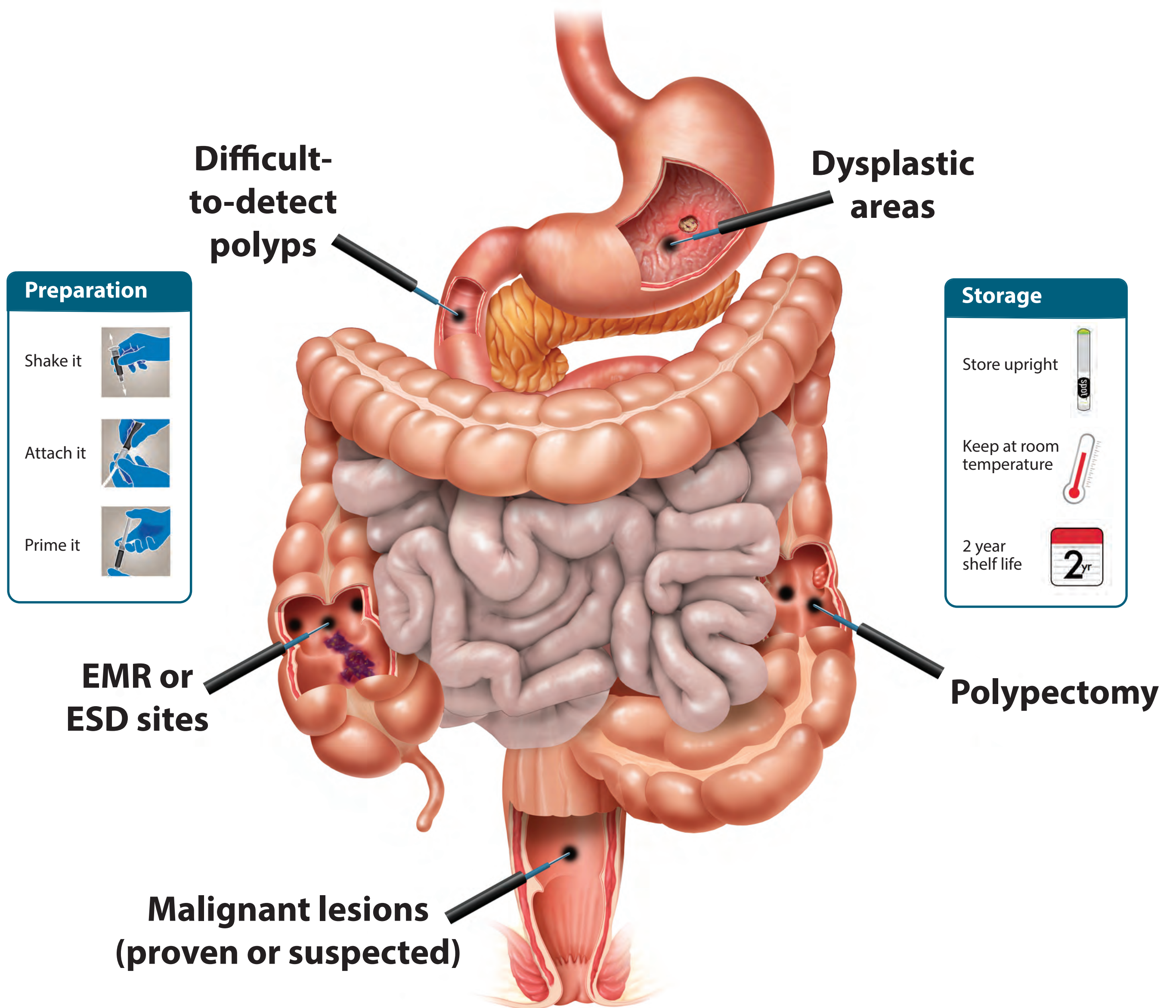

Spot™ Endoscopic Marker

Helping You Win the Fight Against Colon Cancer



Preparation

Shake it 

Attach it 

Prime it 

Storage

Store upright 

Keep at room temperature 

2 year shelf life 

Submucosal Injection¹

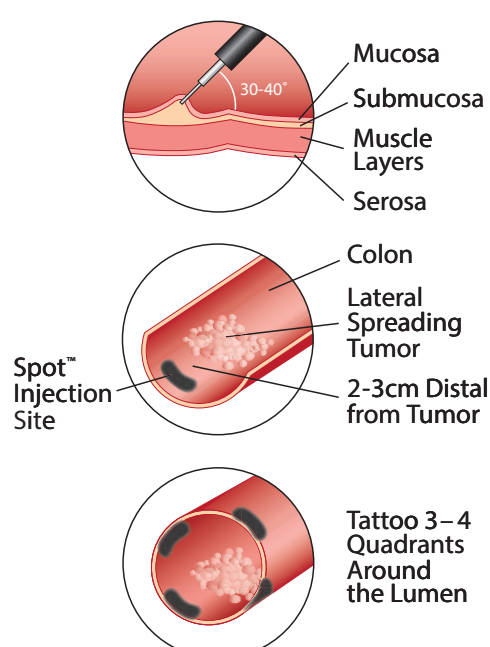

1. Place injection 2-3cm distal (downstream) of the area of interest.
2. Inject tangentially, at a 30-40° angle to the mucosa.
3. Create a saline bleb to find the submucosal plane prior to injecting Spot™ to reduce risk of transmural injection.
4. Place Spot™ tattoos in 3-4 quadrants around the lumen to increase likelihood of seeing it at follow-up.
5. Use 0.5-0.75 mL per injection site, and no more than 8 mL per patient.

Documentation¹

- Use text and photo documentation in your reports with unambiguous terminology.
- Document both the depth of scope and anatomic location of each tattoo.
- Indicate where and how many tattoos were placed at each area of interest.

¹ Rex DK. Driving patient safety with endoscopic tattooing. *Gastroenterology and Endoscopy News*. 2015 May

See Spot™ IFU G44-006L

Tel: +353 1 2014620 | sales@fleetwoodhealthcare.ie | www.fleetwoodhealthcare.ie

G-1238-01-FLE | © 2017 GI Supply. All rights reserved.